

# Electromagnets

(≤18.00")

400V  
(880)

## Energise to Hold

Power required to turn magnet ON. Power removed to turn magnet OFF.

- Sturdy bright nickel plated cylinder, passivated with body mounting
- High-quality permeable iron for low remanence
- Armature plates to suit

**Operating Voltage** 12VDC, 24VDC & 240VAC (with rectified plug connector)  
**Connector Options** Flying leads, two-pole connector and Hirschman connector  
**Mounting** Threaded holes in magnet rear face  
**Finish** Bright nickel plated with machined face  
**ED Rating** 100%  
**IP Rating** 54 (20 for the two-pole connector)



Diameter mm	Standard Operating Voltage						Air Gap mm									
	240VAC Product Number	Current mA	24VDC Product Number	Current mA	12VDC Product Number	Current mA	0	0.09	0.18	0.27	0.36	0.59	1.00	1.59	2.00	4.00
	Pull Force (+/- 10%) Newtons															
20			M52180/24VDC	100	M52180/12VDC	210	53	22	9	5	3	2	1	-	-	-
25			M52172/24VDC	90	M52172/12VDC	180	150	51	22	12	8	4	2	-	-	-
30			M52173/24VDC	140	M52173/12VDC	280	280	149	80	43	26	12	5	2	2	-
40			M52174/24VDC	230	M52174/12VDC	440	550	276	144	83	57	30	14	7	5	3
50	M52175/240VA	40	M52175/24VDC	240	M52175/12VDC	470	1000	655	442	282	187	87	37	24	19	6
65	M52176/240VA	50	M52176/24VDC	340	M52176/12VDC	690	1670	1137	792	533	347	180	78	39	23	11
80			M52183/24VDC	580	M52183/12VDC	1116	2000	1560	1117	715	567	283	130	67	37	20
100			M52184/24VDC	940	M52184/12VDC	1850	3600	2790	2230	1610	1360	1340	470	260	150	60

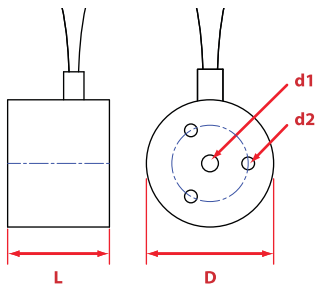

20, 25, 30mm diameter. Free leads (500mm long)  
Leads: 1 red, 1 black. 0.3mm square x 500mm long)

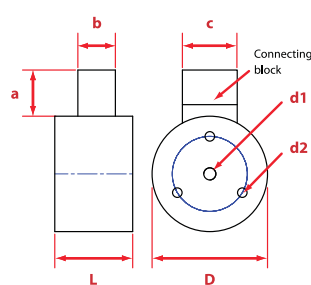

40, 50, 65, 80, 100mm diameter.  
12VDC & 24VDC. Two pole connector

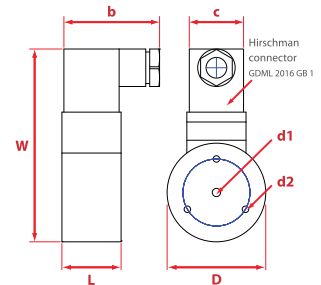

50, 65mm diameter 240VAC.  
Hirschman Connector

Product Number	Dimension mm								PCD mm	Weight g
	D	L	W	A	B	C	D1	D2		
<b>12 &amp; 24V Units</b>										
M52180/24VDC	20	18	-	-	-	-	M4	M3	14	36
M52172/24VDC	25	20	-	-	-	-	M4	M3	15	66
M52173/24VDC	30	24	-	-	-	-	M5	M3	18	108
M52174/24VDC	40	27	-	16	13	19	M5	M4	26	210
M52175/24VDC	50	30	-	16	13	19	M5	M4	34	364
M52176/24VDC	65	35	-	16	13	19	M8	M5	40	710
M52183/24VDC	80	38	-	16	13	19	M8	M6	50	1203
M52184/24VDC	100	43	-	16	13	19	M10	M6	75	2200
<b>240V Units</b>										
M52175/240VA	50	30	98	-	50	30	M5	M4	34	408
M52176/240VA	65	35	111	-	50	30	M8	M5	40	744